

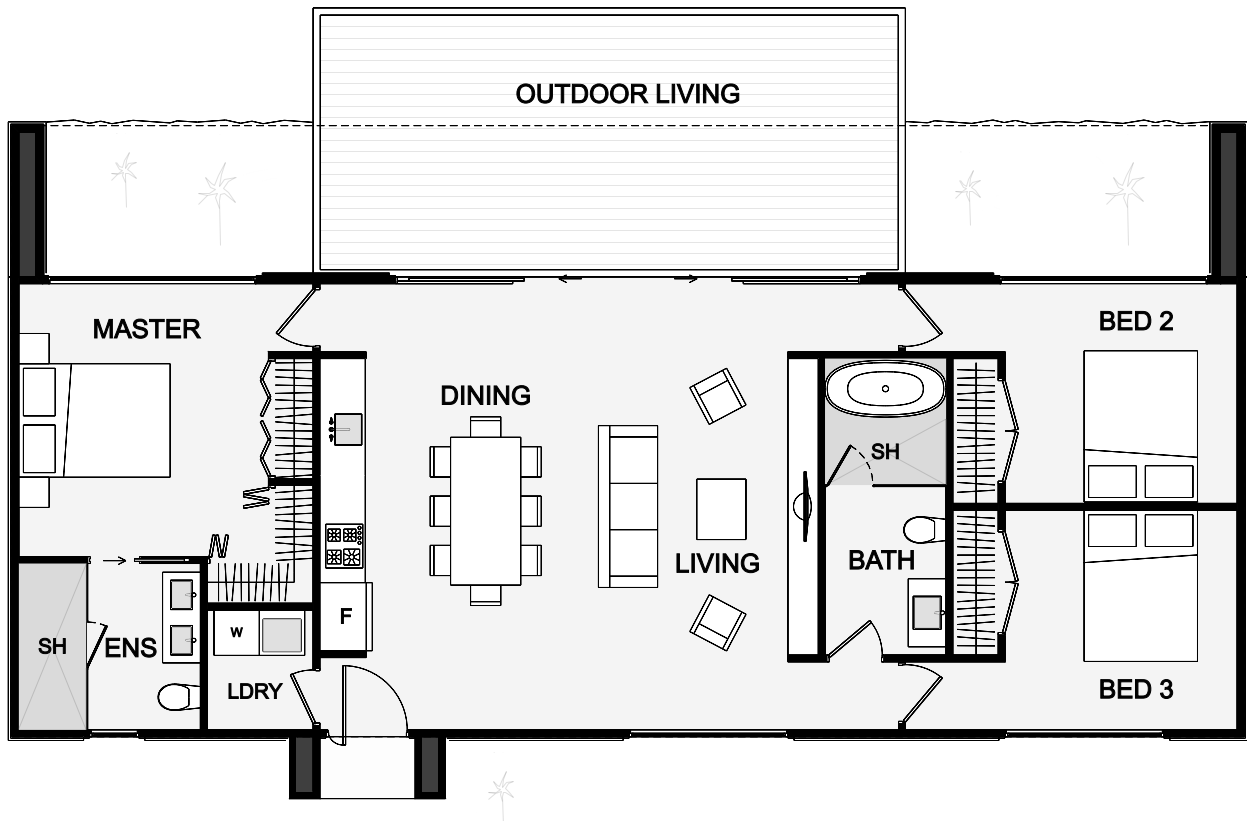

With its simple and modern lines, this design will be sure to excite. The floor plan has been carefully moulded to optimise open living, yet provides the possibility for additional private spaces within the bedrooms. The simple lines and two options of claddings, make this home very attractive to the eye. The possibilities have been seen and utilised both out and inside this home and together, provides the right essentials to meet your needs and make living a pleasure.



Floor Area: 101m²

0
 3
 2
 1
 16.3m
 8.0m

Phone: (06) 3774433
 Mobile: 0274 484728
 Email: warwick@designercourt.co.nz
www.competitivehomeswairarapa



COMPETITIVEHOMES
WAIRARAPA